

MODEL NO.	DC-080DH
SCHEMATIC	
CENTER PIN	ø2mm ø2.5mm

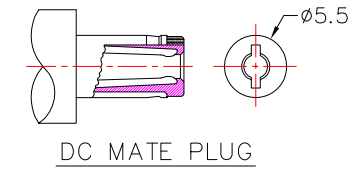

***MATERIAL**

- CENTRE PIN :PHOSPHOR BRONZE
- TERMINAL 1 :BRASS
- TERMINAL 2 :PHOSPHOR BRONZE
- TERMINAL 3 :BRASS
- HOUSING :PA6T
- COVER :PA6T

SPECIFICATION

1. Rating : DC 16V 5.0A
2. Contact resistance : ≤ 50mΩ
3. Insulation resistance : ≥ 100MΩ
4. Withstand voltage : 500VAC
5. Insertion and extraction force : 3-30N
6. life test : 5,000 cycles

CONTACT 建倚科技股份有限公司
CONTACT TECHNOLOGY CORP.

TOLERANCE UNLESS OTHERWISE STATED :
 Up to 5 ±0.2
 Above 5 ~ 15 ±0.3
 Above 15 ~ 30 ±0.4
 Above 30 ~ 50 ±0.5
 Angle ±0.3°

3RD. ANGEL'S UNITS MM

DRAWN BY:	DATE	MAT'L	TITLE	JACK
Jack Lu	08/12/14		MODLE	DC JACK
CHECKED BY:	DATE	FINISH	DWG NO.	DC-080DH-x
Jacky Chen	08/12/14		PART NO.	DC-080DH-x
APPROVED BY:	DATE	SCALE	1 : 1	
Tony Kao	08/12/14	SHEET NO.	1 of 1	
				SIZE A4
				VER R1

1	新增SPEC	Jack	081214
ITEM NO.	DESCRIPTION	DRAWN	DATE