

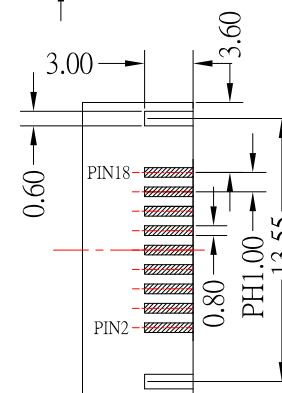

HDMI-19APL3xx-S165

外殼材質:	Blank : BRASS	外殼電鍍材質:	G : Au
	I : SPCC		NI : Nickel

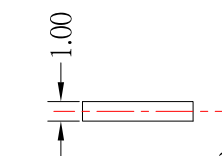
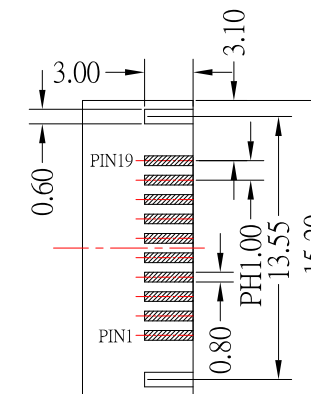
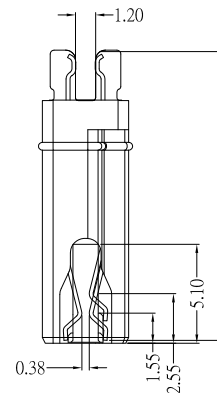
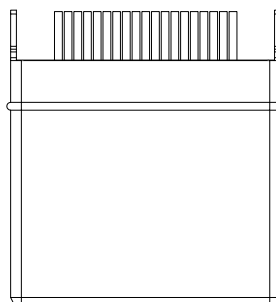
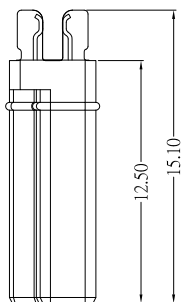
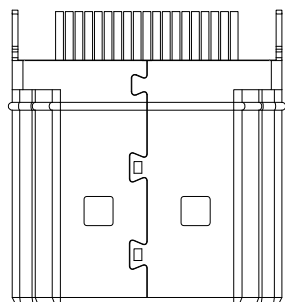
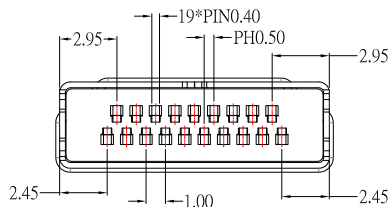

NOTE :

1.SPECIFICATION:

- 1.1 CURRENT RATING: 0.5 Amp Max.
- 1.2 VOLTAGE RATING: 40 V ac(r.m.s) Max.
- 1.3 CONTACT RESISTANCE: 10mΩ Max.
- 1.4 NSULATION RESISTANCE:100MΩ Min.
- 1.5 DIELECTRIC WITHSTANDING VOLTAGE:
AC 500V Min. (for 1 minute)
- 1.6 OPERATION TEMPERATURE RANGE: -25°C~85°C

2.MECHANICAL

- 2.1 INSERTION FORCE: 4.5KGF MAXMUM
- 2.1 WITHDRAWAL FORCE: 1.0KGF MINIMUM;4.0KGF MAXMUM

3.Material:

- 3.1 Housing: LCP
- 3.2 Contact: BRASS
- 3.3 Shell: BRASS / SPCC

4. Finish:

- 4.1 Contact: Plated Gold in Mating Area ;
Tin Plated on Solder Balls ;
Nickel under plated overall
- 4.2 Shell: Nickel / Gold under Plated surface layer

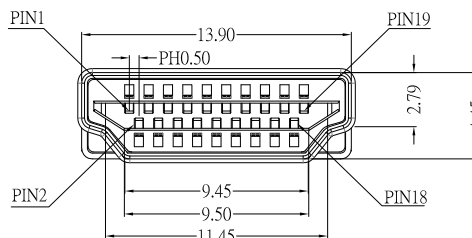

6	更新外殼底部樣式	Jack	112718
5	更新端子鍍層	Jack	112317
4	更新為A0版	Jack	042017
3	更新夾板尺寸	Jack	022515
2	更新鍍層代號及更新pcb layout尺寸	Jack	112714
1	更新鍍層代號	Jack	111214
ITEM NO.	DESCRIPTION	DRAWN	DATE

CONTACT 建倚科技股份有限公司
CONTACT TECHNOLOGY CORP.

TOLERANCE UNLESS OTHERWISE STATED :	Up to 5 ±0.2	3RD. ANGEL'S	UNITS	MM
	Above 5 ~ 15 ±0.3			
	Above 15 ~ 30 ±0.4			
	Above 30 ~ 50 ±0.5			
	Angle ±0.3°			

DRAWN BY:	DATE	MAT'L	TITLE	CONNECTOR
Jack Lu	11/27/18			
CHECKED BY:	DATE	FINISH	MODLE	HDMI A TYPE 夾板公頭 H:1.2mm
Jacky Chen	11/27/18			
APPROVED BY:	DATE	SCALE	DWG NO.	HDMI-19APL3xx-S165
Tony Kao	11/27/18	1 : 1		
		SHEET NO.	PART NO.	HDMI-19APL3xx-S165
		1 of 1		
			SIZE	A4
			VER	A2