

MODEL NO.	DC-079HS-2.5
SCHEMATIC	1 2
CENTER PIN	∅2.5mm

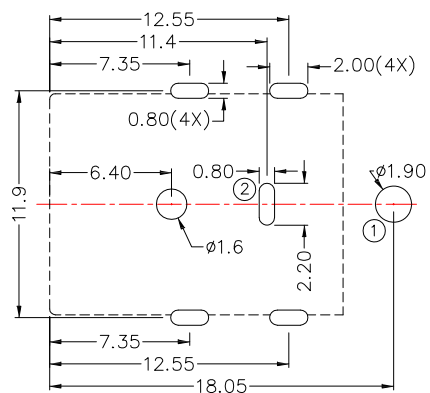

PCB LAYOUT
(TOP VIEW)

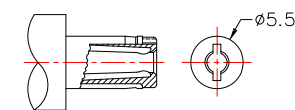
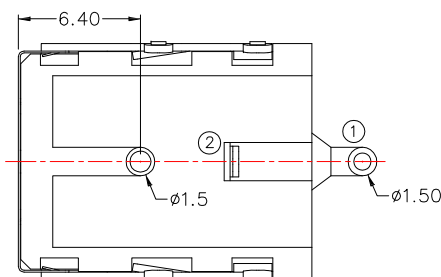

DC MATE PLUG
RATING: DC 20V 7A

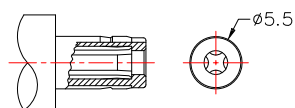

DC MATE PLUG
RATING: DC 20V 10A

***MATERIAL**

- TERMINAL 1 : BRASS
- TERMINAL 2 : PHOSPHOR BRONZE
- STOPPER : C.R.STEEL
- SHIELD-A : C.R.STEEL
- SHIELD-B : STAINLESS STEEL
- HOUSING : PA6T
- COVER : PA6T

SPECIFICATION

- 1.Rating : DC 20V 10A or 20V 7A
- 2.Contact resistance : ≤50mΩ
- 3.Insulation resistance : ≥100MΩ
- 4.Withstand voltage : 500VAC
- 5.Insertion and extraction force : 3-30N
- 6.life test : 5,000 cycles

3	新增剖面圖	Jack	091714
2	新增SPEC	Jack	081214
1	更新材質	Jack	121813
ITEM NO.	DESCRIPTION	DRAWN	DATE

CONTACT 建倚科技股份有限公司
CONTACT TECHNOLOGY CORP.

TOLERANCE UNLESS OTHERWISE STATED :
 Up to 5 ±0.2
 Above 5 ~ 15 ±0.3
 Above 15 ~ 30 ±0.4
 Above 30 ~ 50 ±0.5
 Angle ±0.3°

3RD. ANGEL'S

UNITS MM

DRAWN BY:	DATE	MAT'L	TITLE	JACK
Jack Lu	09/17/14			
CHECKED BY:	DATE	FINISH	MODLE	DC JACK
Jacky Chen	09/17/14			
APPROVED BY:	DATE	SCALE	DWG NO.	DC-079HS-2.5
Tony Kao	09/17/14	1 : 1		
		SHEET NO.	PART NO.	DC-079HS-2.5
		1 of 1		
				SIZE A4
				VER R3